

Guide on how to connect and install Non-Waterproof LED Strips

单色灯条连接图 (Diagrams Of Single Color Flexible LED Strip Connection):

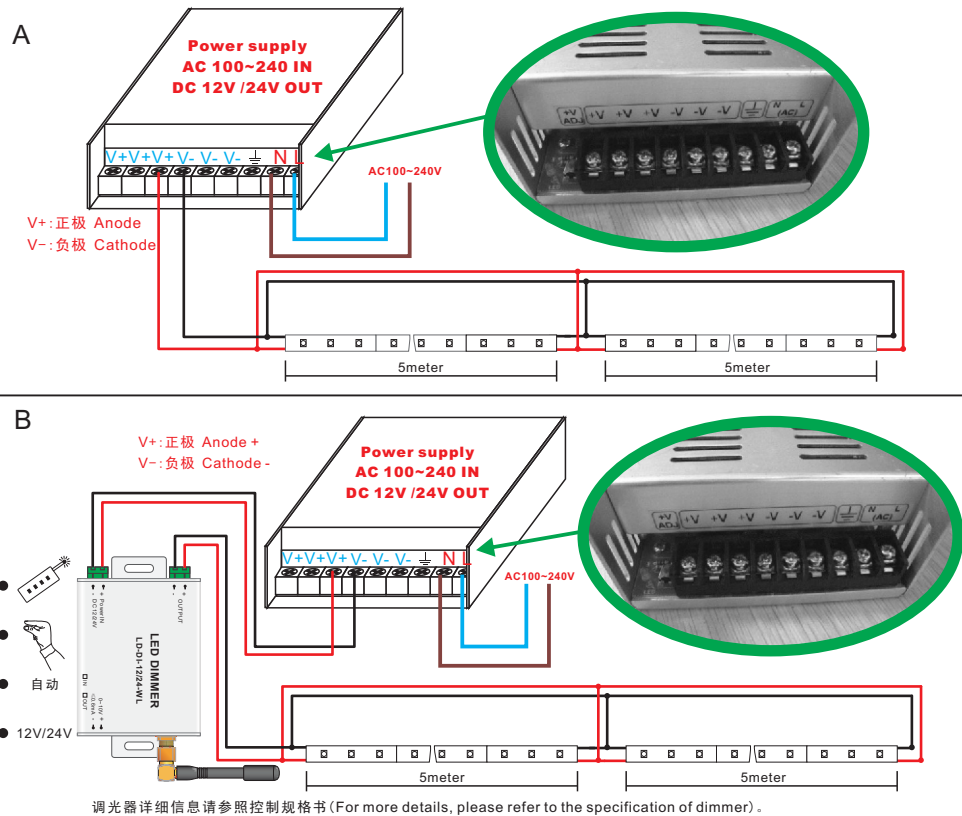

RGB灯条连接控制图 (Diagrams Of RGB Flexible LED Strip Connection):

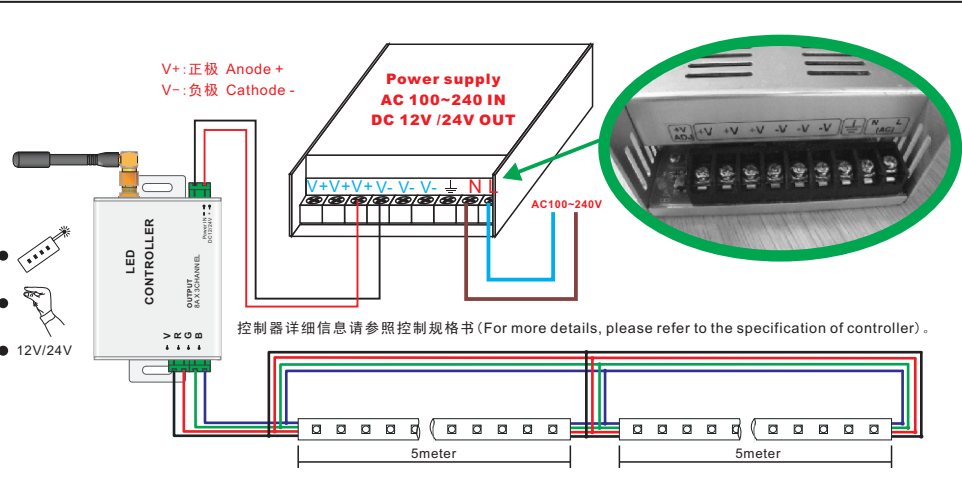

安装(Installation):

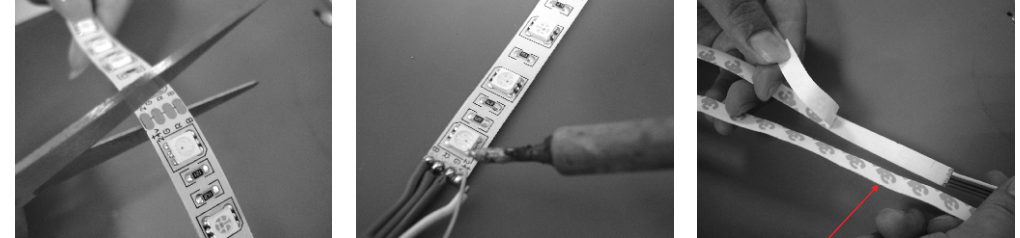

3M 双面胶 (3M self adhesive tape)

安装时只需将双面胶背面的纸撕去,即可安装在各种弯曲平面上,建议先画好定位线,再进行贴灯条时,尽量一次性贴平整,避免返工,撕掉重贴。(Remove the paper on 3M tape and mark a position line on the object before installation. For a good performance, please install evenly and avoid sticking to objects repeatedly.)

注意事项 (Note):

- 灯条印有“剪刀标示”处可延剪切线剪断,同时,剪断的另一处可再次接上电缆线,即可使用;注意,正负极不可颠倒。(The flexible strips can be cut or rejoined at the cuttable line. Solder the wires to the anode and cathode on PCB before using. Be sure they are not reversed.)
- 灯条电压为DC 12/24V,切勿直接连接高压220V;(Power supply should be DC 12V or 24V. Do not connect the strips to AC 220V directly.)

为了更合理使用,请在安装前阅读如下几点,敬请保留,以备参考:

- 按包装上的额定电压使用,勿在电压过高或过低的状态下使用。
- 不可安装在可燃物体内使用,任何情况下,灯条不能被隔热衬垫或类似材料盖住。
- 禁止在室内外雨水淋到的地方使用。
- 安装更换灯条之前,必须先切断电源,确保灯条安全。
- 当发现灯条工作异常时,请检查灯条输入电压和正负极是否正常。
- 使用LED灯条时,建议使用我公司配套的驱动电源。

Please read the following instructions before installation:

- This product should be used at the rated voltage which shows on the package. Service voltage should not beyond the designated range.
- Do not install or use it inside combustibles. It should not be covered by heat-insulated materials or similar materials in any situation.
- For LED strip safety, please switch off the power supply before installation or replacement.
- This product is non-waterproof. Please protect it from water.
- If the LED strip is not working well, please check the input power and also the connection, make sure "+" and "-" are not reversed.
- You are suggested using the LED drivers we offered for LED strips.